

Ø150mm Rising Main to tie into existing previously constructed from adjacent development. Refer to drawing 10906-2105 for details.

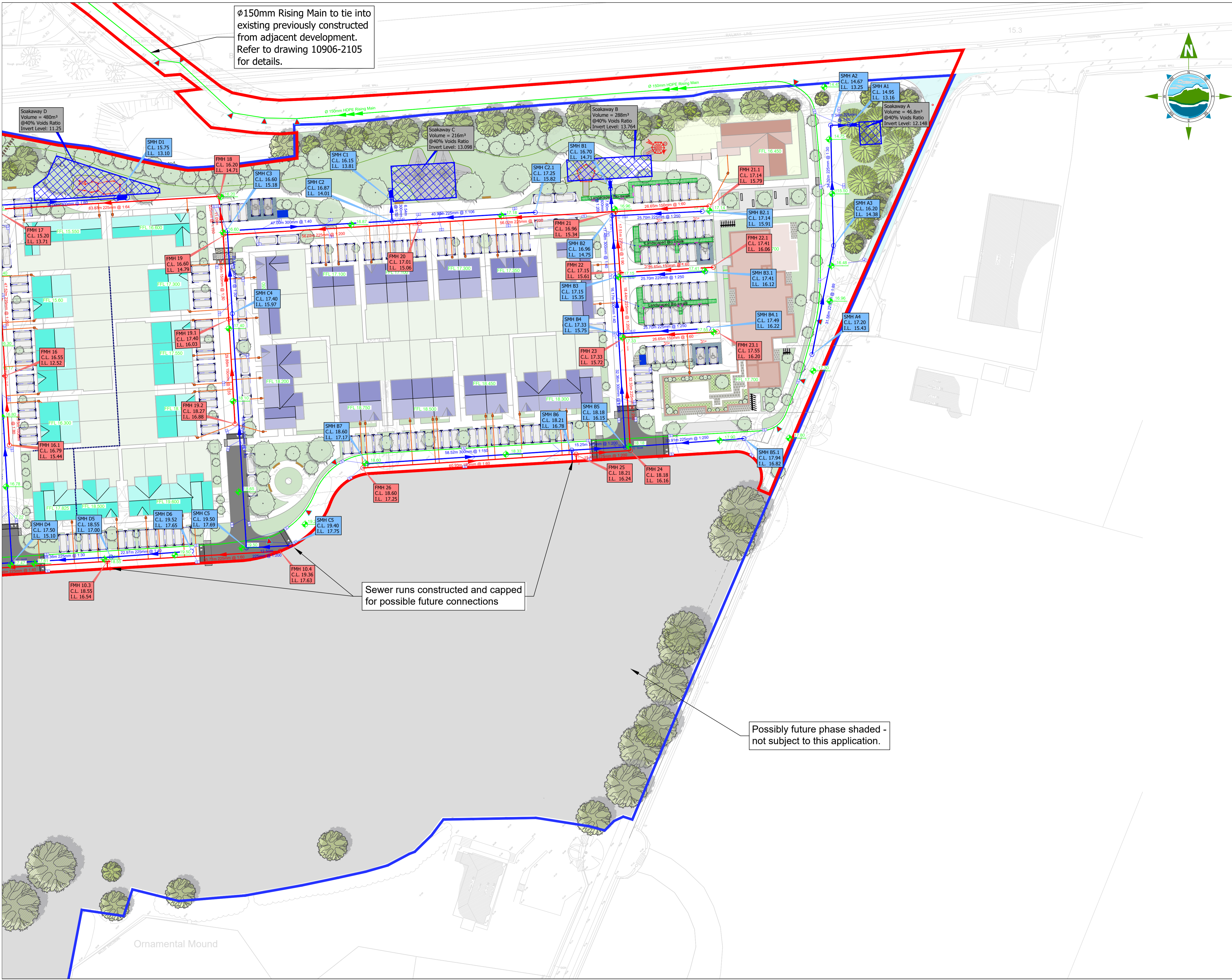

Possibly future phase shaded - not subject to this application.

THE INFORMATION ON THIS DRAWING IS TO THE ORDNANCE SURVEY IRELAND ITM COORDINATE SYSTEM

- LEGEND:**
- Site Boundary
  - Existing Rising Main
  - Proposed Ø150mm HDPE Rising Main
  - Proposed Foul Sewer and Manhole
  - Proposed Inspection Chamber and Connection
  - Proposed Storm Sewer and Manhole
  - Proposed Soakpit
  - ▲ Rising Main Thrust Block
  - Proposed Level
  - Road Gully & Connection to Storm Sewer
  - Bio-Swale Overflow to Storm Sewer
  - Drop Kerb to Bio-Swale
  - Possible Future Phase of Lands - Not Subject to this Planning Application
  - Proposed Bio-Swale
  - Lands in Control of Applicant

- NOTES:**
- FIGURED DIMENSIONS ONLY TO BE TAKEN FROM THIS DRAWING.
  - ALL DRAWINGS TO BE CHECKED BY THE CONTRACTOR ON SITE.
  - ENGINEER/EMPLOYERS REPRESENTATIVE, AS APPROPRIATE, TO BE INFORMED BY THE CONTRACTOR OF ANY DISCREPANCIES BEFORE ANY WORK COMMENCES.
  - THE CONTRACTOR SHALL UNDERTAKE A THOROUGH CHECK FOR THE ACTUAL LOCATION OF ALL SERVICES/UTILITIES, ABOVE AND BELOW GROUND, BEFORE ANY WORK COMMENCES.
  - ALL LEVELS SHOWN RELATE TO ORDNANCE SURVEY DATUM AT MALIN HEAD.

Rev	Date	Description	By	Chkd.
P05	28.06.2021	Revised Layout - Issued for Planning	MN	RD
P04	16.06.2021	Issue for Planning Revision to Drainage	EC	RD
P03	19.05.2021	Draft Issue For Planning	EC	SH
P02	14.05.2021	Issued For Comment	MN	SH
P01	12.05.2021	First Issue	MN	RD

Client: **ALBER DEVELOPMENTS**

Project: **Roshill Residential Development**

Title: **Drainage Layout (Sheet 2 of 2)**

Scale @ A1: **1:500 / @A3 1:1000**

Prepared by: **MN** Checked: **RD** Date: **June 2021**

Project Director: **Michael McDonnell**

Drawing Status: **Planning**

**TOBIN CONSULTING ENGINEERS**

Galway Office  
Fairgreen House, Fairgreen Road,  
Galway, H91 AXK8,  
Ireland.

Tel: +353 (0)91 565 211  
www.tobin.ie

Drawing No.: **10690-2104P05**